



# Micro MAG 340 Riser Assembly Instructions

**IMPORTANT INFORMATION. READ CAREFULLY. KEEP THIS INFORMATION FOR FUTURE REFERENCE.**

These instructions are for assembly of your new Excalibur crossbow only, please refer to your Owner's Manual for information on how to use, care for and maintain your Excalibur crossbow. **NOTE: IMAGES MAY NOT BE EXACTLY AS PRODUCED, THEY HAVE BEEN MODIFIED FOR INSTRUCTIONAL PURPOSES.**

## ASSEMBLING YOUR MAG CROSSBOW IS EASY

**Step 1:** Locate stock assembly, riser assembly, barrel nut, 3/16 hex allen key & 5/16-18 x 2.25" long flat head cap screw:

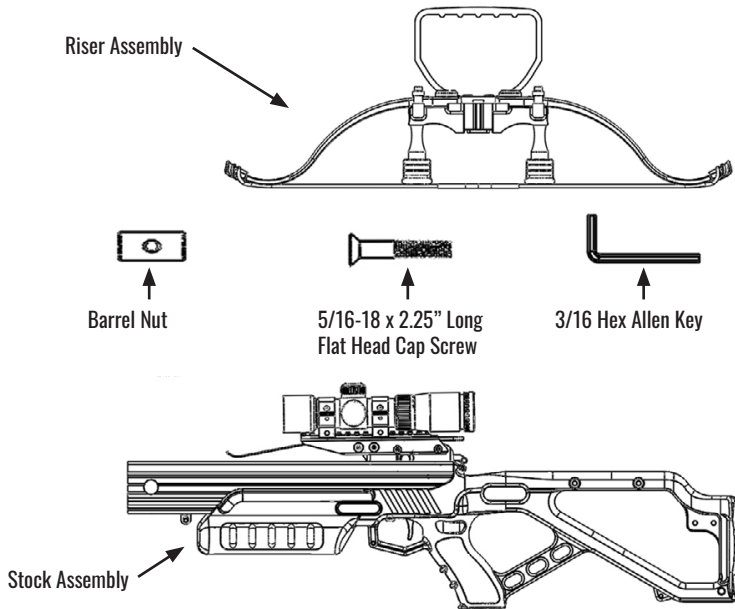

**Step 2:** Insert barrel nut into hole in mainframe, ensure one of the threaded holes in the barrel nut is oriented towards the front of the bow, equal amounts of the barrel nut should protrude from both sides of mainframe once properly centred:

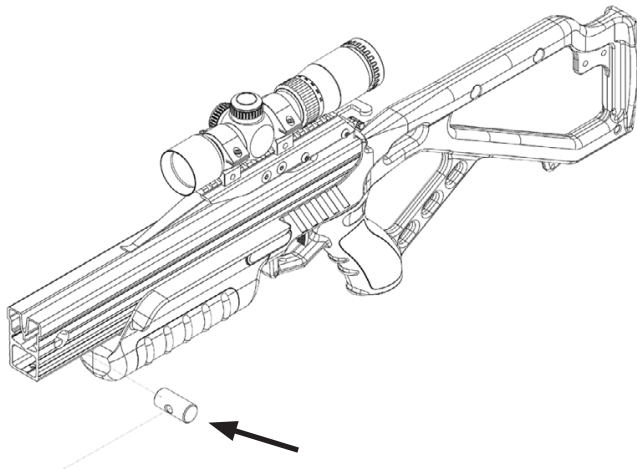

**Step 3:** Align the riser assembly with the stock assembly:

**NOTE:** Confirm the top of the riser and mainframe are flush after assembly

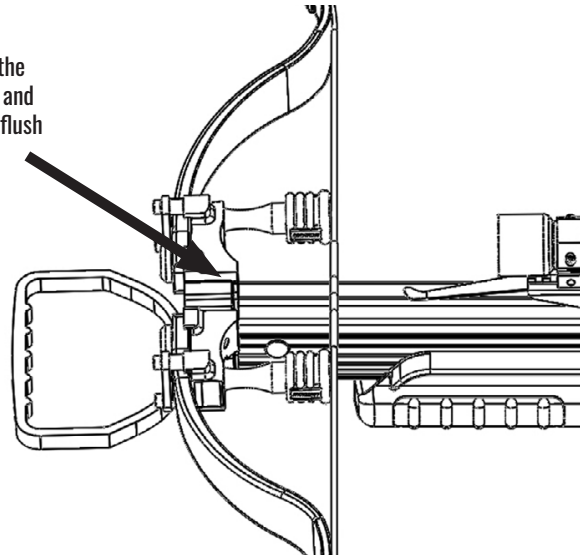

**Step 4:** Insert 5/16-18 x 2.25" flat head cap screw through the riser assembly and thread into the barrel nut, you may need to rotate the barrel nut slightly to perfect the thread and fastener alignment. Tighten with 3/16" allen key:

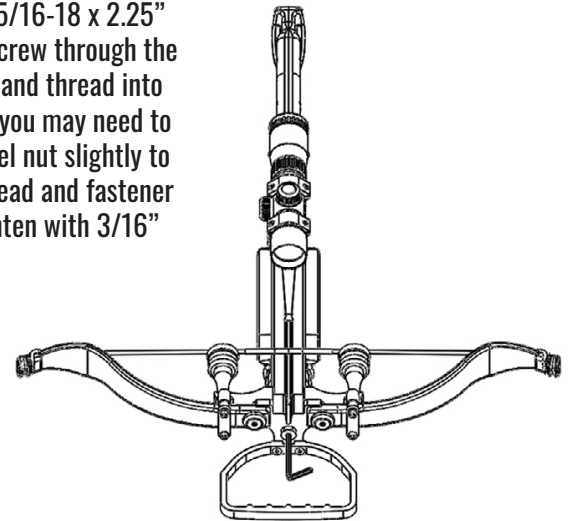

**Step 5:** FOLLOW QUIVER MOUNTING INSTRUCTIONS TO COMPLETE ASSEMBLY.