

ASSEMBLING THE TAKE DOWN (TD) WITH QUICK LOC TECHNOLOGY RISER/MAINFRAME:

1. WITH THE STIRRUP IN THE OPEN POSITION, SLIDE THE RISER ONTO THE MOUNT BAR LOCATED ON THE FRONT OF THE MAINFRAME ASSEMBLY, PUSH TOGETHER FOR SNUG FIT.

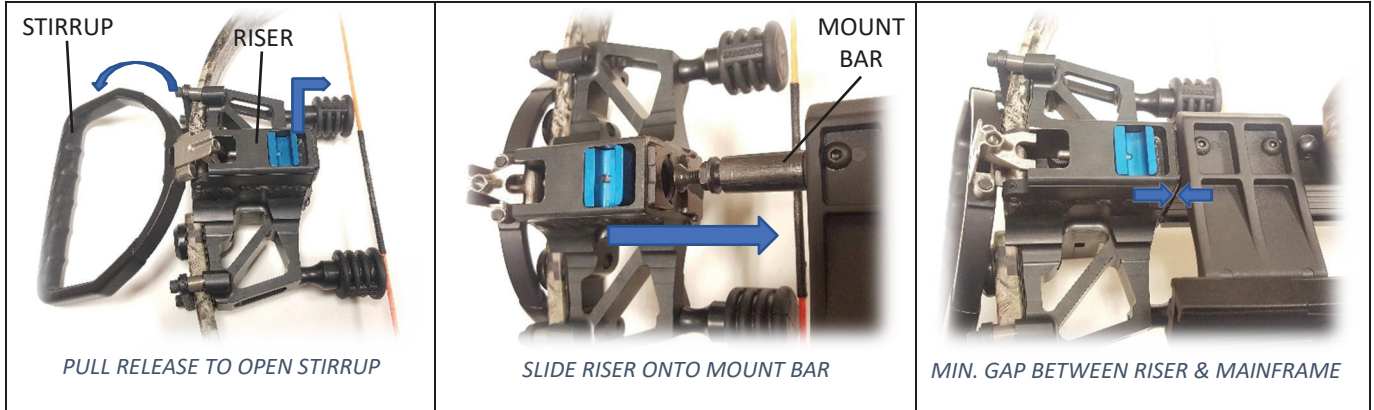

2. PULL BACK ON STIRRUP UNTIL THE BLUE RELEASE “CLICKS”, ENSURE RELEASE IS FULLY CLOSED

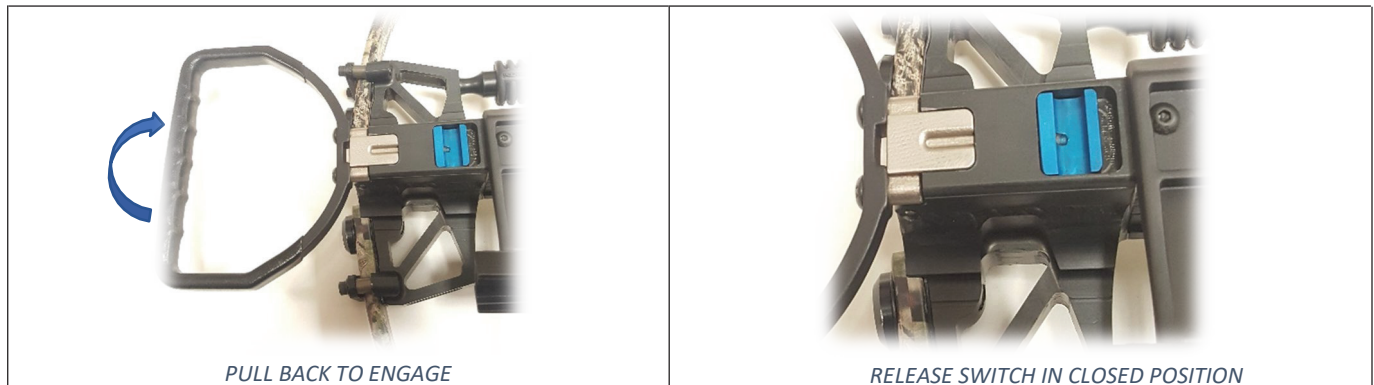

DIS-ASSEMBLING THE TAKE DOWN (TD) WITH QUICK LOC TECHNOLOGY RISER/MAINFRAME:

1. WHILE PULLING BACK ON STIRRUP, APPLY PRESSURE TO RELEASE SWITCH, WHEN RELEASE SWITCH ACTIVATES, LET THE STIRRUP FALL FORWARD TO OPEN POSITION.

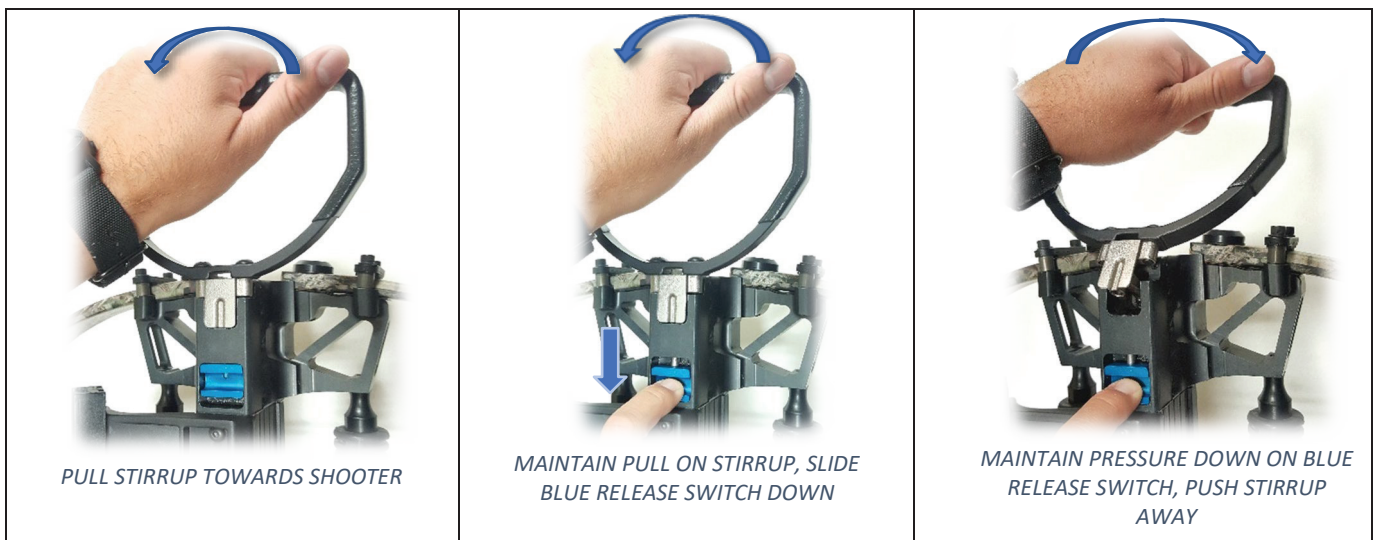

2. REACH THROUGH THE OPEN STIRRUP AND GRASP THE CENTRE OF THE RISER AROUND THE BROADHEAD CLEARANCE GROOVE, PULL RISER ASSEMBLY AWAY FROM MAINFRAME ASSEMBLY WHILE HOLDING BOTH ASSEMBLIES FIRMLY



TROUBLESHOOTING:

ISSUE: WHEN ASSEMBLING FRONT END, THE STIRRUP IS TIGHT, AND THE RELEASE WILL NOT CLICK CLOSED PROPERLY

SOLUTION: PULL THE RISER FROM THE MAINFRAME ASSEMBLY. LOOSEN MOUNT BAR JAM NUT WITH 7/16" WRENCH AND **LOOSEN** CLAMP SCREW BY ¼ TURN. RE-TIGHTEN MOUNT BAR JAM NUT. RETRY ASSEMBLY. IF STILL TIGHT REPEAT THIS PROCESS FOR AN ADDITIONAL LOOSENING ¼ TURN.

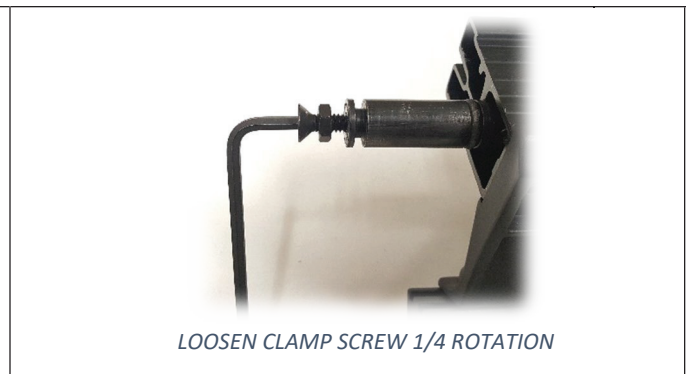
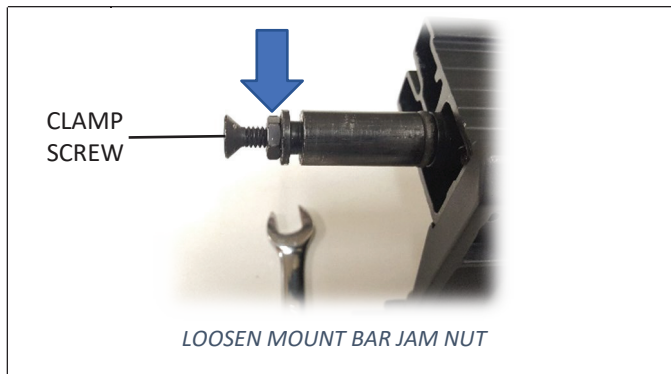

ISSUE: WHEN ASSEMBLING FRONT END, THE RISER AND MAINFRAME ARE NOT TIGHT TOGETHER.

SOLUTION: PULL THE RISER FROM THE MAINFRAME ASSEMBLY. LOOSEN MOUNT BAR JAM NUT AND **TIGHTEN** CLAMP SCREW BY ¼ TURN. RE-TIGHTEN MOUNT BAR JAM NUT. RETRY ASSEMBLY PROCESS. IF STILL FEELING LOOSE, REPEAT THIS PROCESS FOR AN ADDITIONAL TIGHTENING ¼ TURN.

